

ELECTROMAGNETIC SERVICE BRAKES

MAIN CHARACTERISTICS	OPTIONS
<ul style="list-style-type: none"> • FAILSAFE BRAKE BY SPRING APPLICATION • ELECTROMAGNETIC RELEASE • OPENING PROVING SWITCH 	<ul style="list-style-type: none"> • MECHANICAL RELEASE LEVER • HYDRAULIC RELEASE • CLOSING PROVING SWITCH • MANUAL RELEASE CONTROL SWITCH • HIGH TEMPERATURE, IRON AND STEEL CONDITIONS



645-650-660

- Association with discs Ø175 to 625
- Manual wear compensation
- Option:
Mounting on a vertical axis disc



**5K - 5D
45K - 45D**

- Association with discs Ø315 to 625
- Automatic wear compensation
- Option:
Mounting on a vertical axis disc

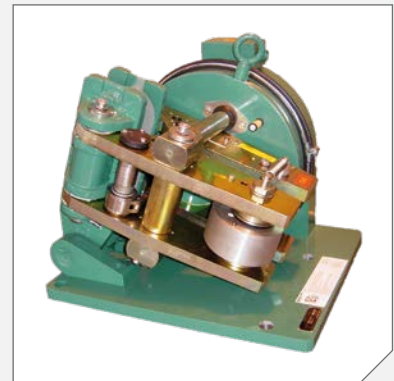

**4CA2 - 3CA2
2CA2 - 1CA2**

- Association with discs Ø445 to 995
- Automatic wear compensation
- Left and right hand calipers
- Option: Manual wear compensation

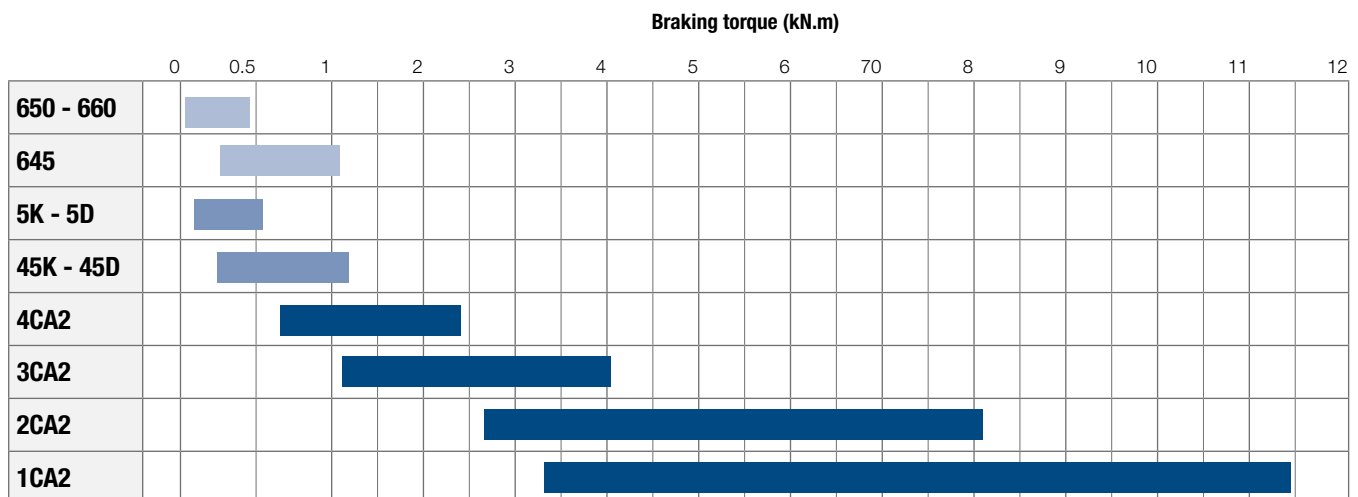

SIME Brakes Industrial Braking Systems

Service Brakes

DISC BRAKE - 650 AND 660 CALIPERS

Revision number: T03150-01-F

Revision date: 21.03.2016

Fail safe braking
Spring application
Electromagnetic release
Manual lining wear compensation
Brake pads with wear indicator
Opening proving switch for PLC
With coil supply wire: 2 x 2mm², length 2m

Conditions of use:

- Ambient temperature -10°C to +60°C
- Relative humidity ≤ 70%
- Dust in atmosphere ≥ 65µ

Other conditions, consult SIME-Stromag.

Use:

- Service brake for application ≤ 150 stops/h

Options:

- Manual release lever or hydraulic release
- Mounting on vertical axis disc
- Marine protection
- Closing proving switch
- Manual release switch

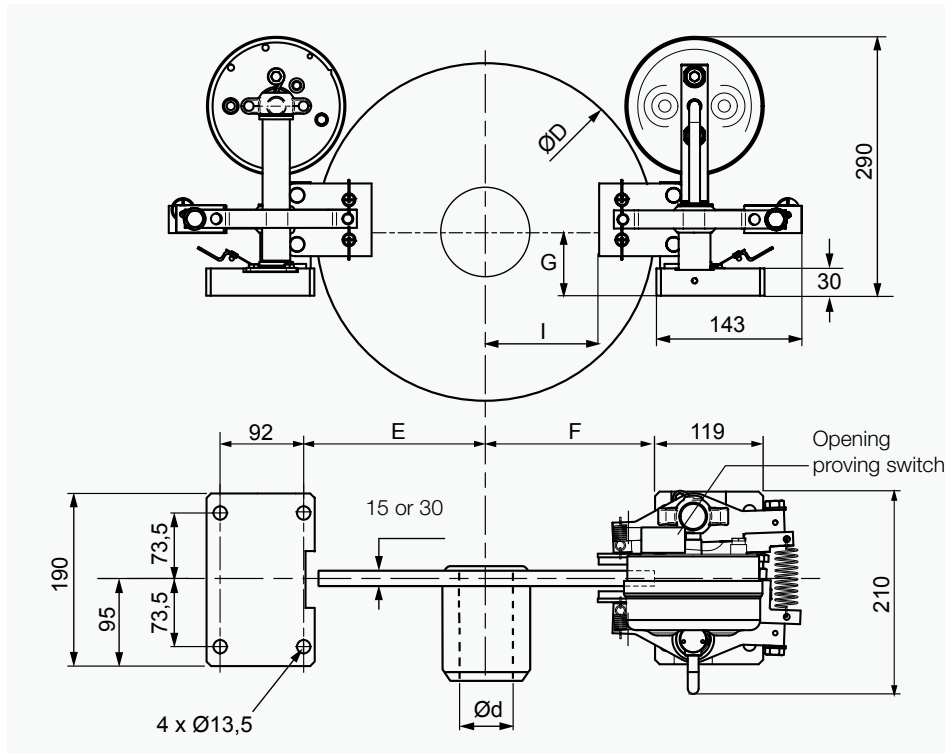

Opening proving switch :
250VAC maxi., 5A maxi., with interrupting capacity: 50VA maxi.
220VDC maxi., 5A maxi., with interrupting capacity: 50W maxi.

Compatible with PLC (Programmable Logic Controllers). An opening switch used with other equipment than PLC must not be reused with a PLC.

The opening switch is delivered with 3 x 0.75mm² cable, length 2m

Weight: 19 kg
Dimensions in mm

Response time at nominal torque : see the leaflet of the associated electrical power supply.

Discs			Thickness 15 mm								Thickness 30 mm							
Maximum speed of the disc for nominal torque	tr/mn		5000	4300	3600	3000	2400	2100	1900	1800	1500	3000	2700	2400	2100	1900	1800	1500
D	mm		175	220	260	315	395	445	495	550	625	315	355	395	445	495	550	625
d	mm		0-40	0-55	0-75	0-75	0-75	0-75	0-100	0-100	0-100	0-50	0-60	0-70	0-70	0-100	0-100	0-100
E	mm		118	128	143	173	213	238	263	293	328	173	193	213	238	263	293	328
F	mm		106	116	131	161	201	226	251	281	316	161	181	201	226	251	281	316
G	mm		85	85	85	75	60	50	45	45	25	75	60	50	45	45	25	25
I (approx. dimension)	mm		43	53	68	98	138	163	188	218	253	98	118	138	163	188	218	253
Caliper 650 :																		
Nominal torque for 1 caliper adjustable from 100% to 50%		N.m	110	130	150	190	260	300	350	390	460	190	220	260	300	350	390	460
Max. reaction on shaft	1 caliper	N	1600								1600							
	2 calipers	N	0				260	570	580	560	510	680	260	550	570	580	560	510
Caliper 660 :																		
Nominal torque for 1 caliper adjustable from 100% to 60%		N.m	55	65	75	95	130	150	175	195	230	95	110	130	150	175	195	230
Max. reaction on shaft	1 caliper	N	800								800							
	2 calipers	N	0				130	285	290	280	255	340	130	275	285	290	280	255

DISC BRAKE - 645 CALIPER

Revision number: T03250-01-D

Revision date: 21.03.2016

Fail safe braking
 Spring application
 Electromagnetic release
 Manual wear compensation
 Brake pads with wear indicator
 Opening proving switch for PLC
 With coil supply wire: 2 x 2mm², length 2m

Conditions of use:

- Ambient temperature -10°C to +60°C
- Relative humidity ≤ 70%
- Dust in atmosphere ≥ 65µ
- Other conditions, consult us.

Use:

- Service brake for application ≤ 150 stops/h

Options:

- Manual release lever or hydraulic release
- Mounting on vertical axis disc
- Marine protection
- Closing proving switch
- Manual release switch

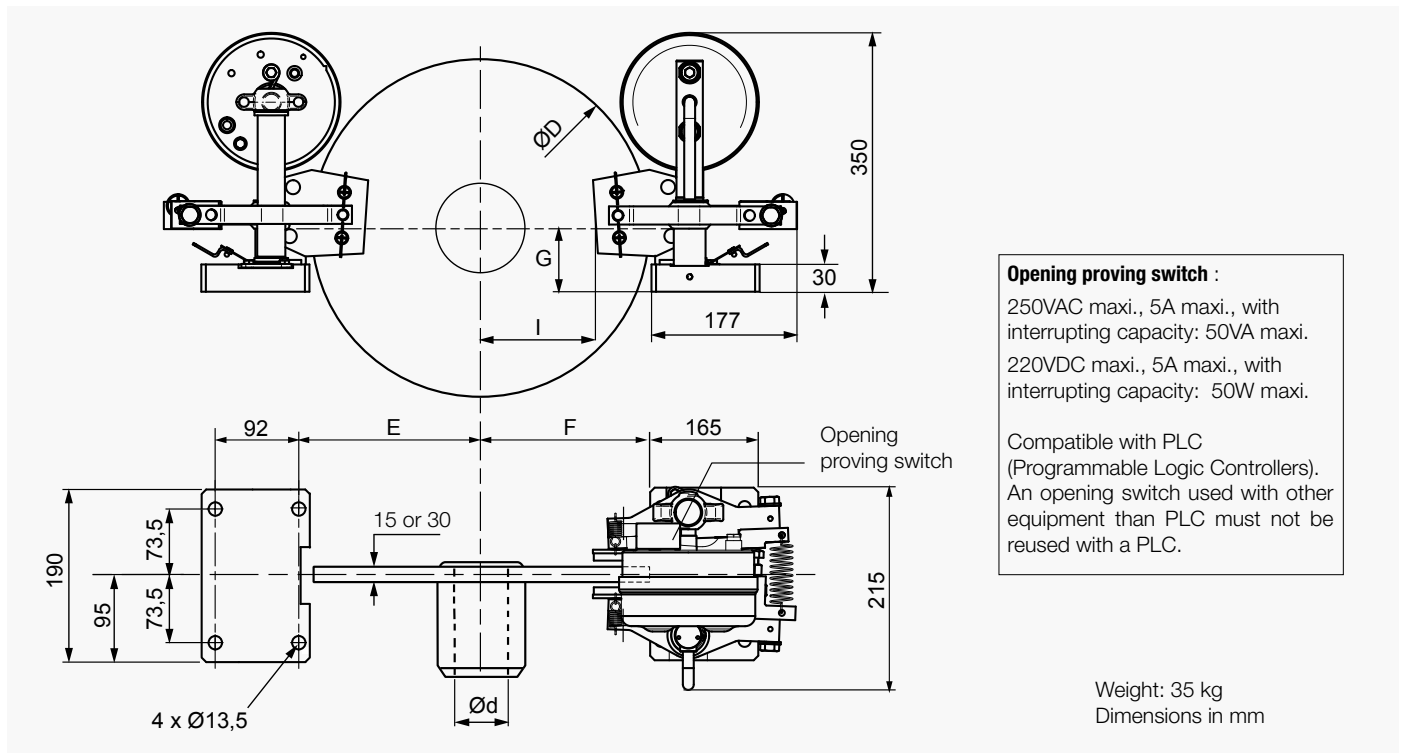

Opening proving switch :
 250VAC maxi., 5A maxi., with interrupting capacity: 50VA maxi.
 220VDC maxi., 5A maxi., with interrupting capacity: 50W maxi.

Compatible with PLC (Programmable Logic Controllers).
 An opening switch used with other equipment than PLC must not be reused with a PLC.

Weight: 35 kg
 Dimensions in mm

Response time at nominal torque : see the leaflet of the associated electrical power supply.

Designation	Discs	solid and thickness 15 mm							self-ventilated and thickness 30 mm							
Nominal torque for 1 caliper adjustable from -30% to +20%	N.m	380	520	600	700	780	920	380	440	520	600	700	780	920		
Maximum speed of the disc for nominal torque	rpm	3000	2400	2100	1900	1800	1500	3000	2700	2400	2100	1900	1800	1500		
D	mm	315	395	445	495	550	625	315	355	395	445	495	550	625		
d	mm	0-75	0-75	0-75	0-100	0-100	0-100	0-50	0-60	0-70	0-70	0-100	0-100	0-100		
E	mm	173	213	238	263	293	328	173	193	213	238	263	293	328		
F	mm	161	201	226	251	281	316	161	181	201	226	251	281	316		
G	mm	95	80	70	65	65	45	95	80	80	70	65	65	45		
l (approx. dimension)	mm	76	116	141	166	196	231	76	96	116	141	166	196	231		
Max. reaction on shaft	1 caliper	N	3850							3850						
	2 calipers	N	405	405	810	895	780	1230	405	515	450	810	895	780	1230	